

PROTECTIVE CAP

240.92.---

Series : ACC-COAX

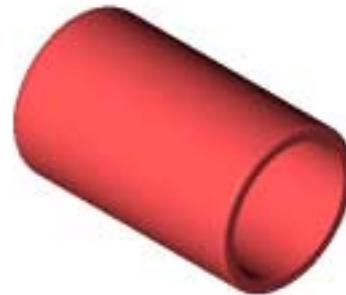
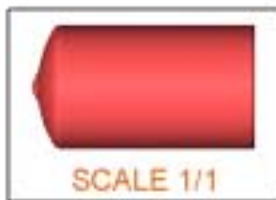
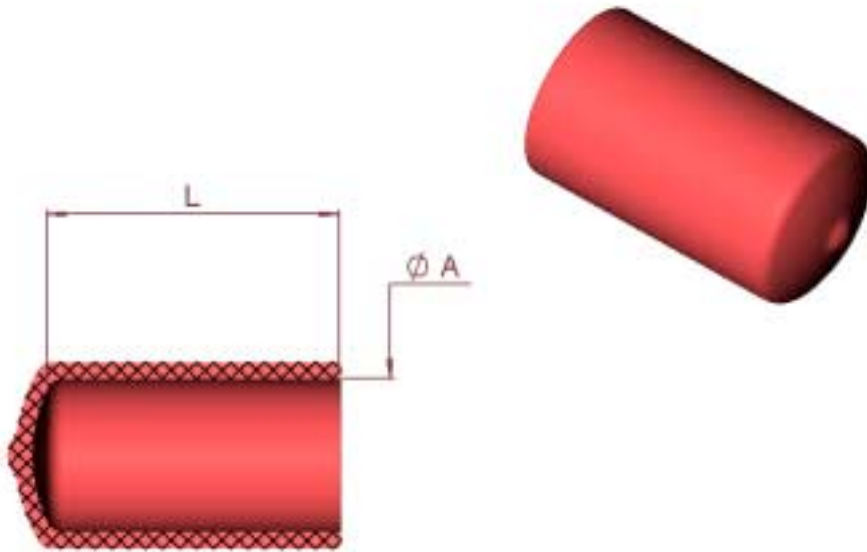

All dimensions are in mm.



COMPONENTS	MATERIALS	PLATINGS (µm)
BODY	-	-
CENTER CONTACT	-	-
OUTER CONTACT	-	-
INSULATOR	-	-
GASKET	-	-
OTHERS PARTS	- RED VINYL EXTRA FLEXIBLE	-

Operating temperature : °C

Weight : 0,0000 g

Others characteristics :

Issue : 0725 A

In the effort to improve our products, we reserve the right to make changes judged to be necessary.



PROTECTIVE CAP

240.92.---

Series : ACC-COAX

Ø A	L	Références	Utilisations
4	11,1	240.92.681	SSMA Female SMC Male plug 1.0/2.3 Female BMA Male MCX Female
5	11	241.92.110	QMA Female QRE Female
6	11,1	240.92.682	SSMA Male SMB Female
6	19	240.92.671	SMA Female SMC Female jack BMA Female
8,7	19	240.92.672	SMA Male
9	19	240.92.684	QMA Male QN Female
10,3	22,2	240.92.673	TNC Female QRE Male BNC Female BNC HT Female
13,5	25,4	240.92.674	TNC Male C Female
14,3	22,2	240.92.675	BNC Male BNC HT Male TNC 18 M
15,9	25,4	240.92.676	N Female
17,4	25,4	240.92.677	C Male QN Male
19	25,4	240.92.678	N Male HN Female
19,5	14	240.92.090	HN Female
20,63	12,7	A240.92.010	7/16 Male
29	10,5	241.92.040	7/16 Female

Issue : 0725

A

In the effort to improve our products, we reserve the right to make changes judged to be necessary.

