

IN SERIES ADAPTERS

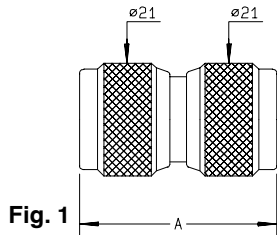

Fig. 1

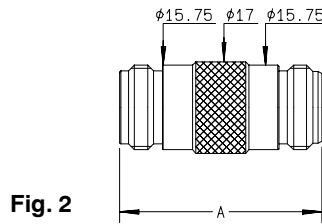

Fig. 2

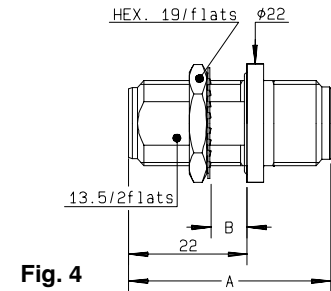

Fig. 4

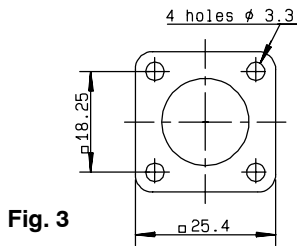

Fig. 3

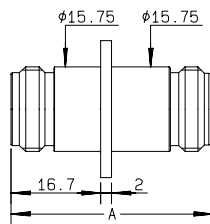

Fig. 5

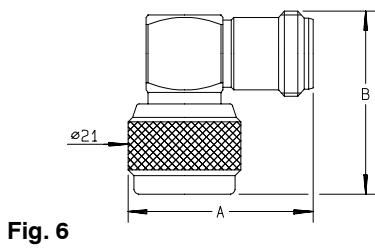
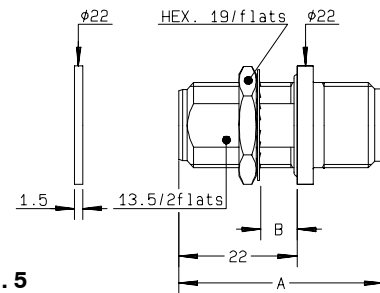

Fig. 6

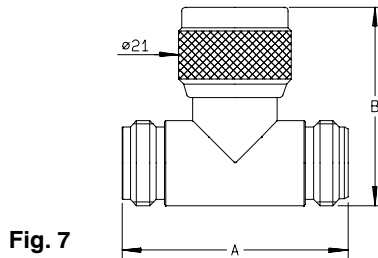

Fig. 7

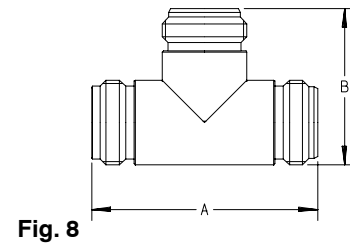

Fig. 8

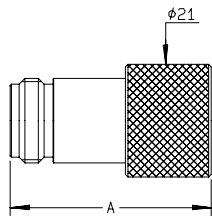

Fig. 9

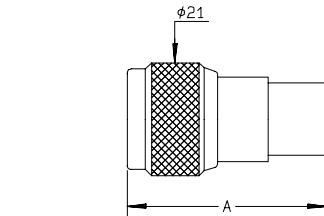

Fig. 10

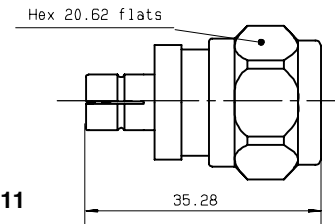

Fig. 11

part number	fig.	dimensions (mm)		panel	note
		A	B		
R161 703 000	1	36.7			M - M
R161 705 000	2	37.5			F - F
R161 715 000	3	37.5		P01	F - F / Flange
R161 730 000	4	37.5	6.5	P10	F - F / Bulkhead panel sealed
R161 753 000	5	38	6.5	P10	F - F / Hermetic / bulkhead
R161 771 000	6	34.4	34		M - F / Right-angle
R161 780 000	7	42	36.9		TEE F - F/M
R161 782 000	8	42	29.1		TEE F - F/F
R161 791 500	9	37.37			Push - on male / female screwing*
R161 791 530●	10	37.12			screwing male / Push - on female*
R161 792 500●	11	37.12			Push - on male / male screwing*

* Push-on adapter, see our catalog D1 036 DE

Note : standard packaging = 50 pieces. For unit packaging, add "W" after the P/N.