

COPPER TUBE CRIMPING LUGS HR120

for Copper conductors

HR series lugs are manufactured from electrolytic Copper tube and designed to obtain high electrical conductivity combined with the mechanical strength required to resist vibration and pull out. Cembre lugs are annealed and Tin plated for improved surface protection.

The annealing process optimises the structural features of the material allowing easier crimping and greater resistance to mechanical stresses.

The barrel entrance of the lug is chamfered to allow easy conductor insertion, while its length facilitates precise positioning in the crimping die.

Each lug is marked with:

- > Cembre logo and part code.
- > conductor type and csa (mm²).
- > stud Ø (mm).
- > crimping die code



COPPER TUBE CRIMPING LUGS HR120

Technical characteristics

Material (Body)

ETP electrolytic tinned Copper

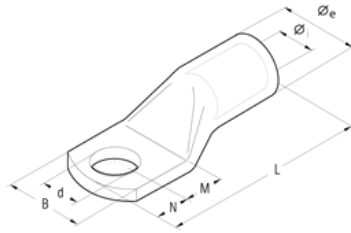

COPPER TUBE CRIMPING LUGS HR120

List of products

HR120 *Cable type: copper, Maximum section: 120 mm²*



Type	Ø	Øi	Øe	B	M	N	L	d	Pack qty
HR120-8	8 mm	15 mm	19.5 mm	29 mm	14 mm	14 mm	67.5 mm	8.4 mm	25
HR120-10	10 mm	15 mm	19.5 mm	29 mm	14 mm	14 mm	67.5 mm	10.5 mm	25
HR120-12	12 mm	15 mm	19.5 mm	29 mm	14 mm	14 mm	67.5 mm	13.2 mm	25
HR120-14	14 mm	15 mm	19.5 mm	29 mm	15 mm	15 mm	69.5 mm	15 mm	25
HR120-16	16 mm	15 mm	19.5 mm	31 mm	18 mm	16 mm	73.5 mm	17 mm	25
HR120-20	20 mm	15 mm	19.5 mm	36 mm	22 mm	21 mm	82.5 mm	21 mm	25

HR120 *Cable type: flexible copper, Maximum section: 120 mm²*

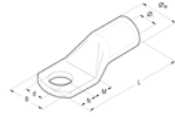

Type	Ø	Øi	Øe	B	M	N	L	d	Pack qty
HR120-8	8 mm	15 mm	19.5 mm	29 mm	14 mm	14 mm	67.5 mm	8.4 mm	25
HR120-10	10 mm	15 mm	19.5 mm	29 mm	14 mm	14 mm	67.5 mm	10.5 mm	25
HR120-12	12 mm	15 mm	19.5 mm	29 mm	14 mm	14 mm	67.5 mm	13.2 mm	25
HR120-14	14 mm	15 mm	19.5 mm	29 mm	15 mm	15 mm	69.5 mm	15 mm	25
HR120-16	16 mm	15 mm	19.5 mm	31 mm	18 mm	16 mm	73.5 mm	17 mm	25
HR120-20	20 mm	15 mm	19.5 mm	36 mm	22 mm	21 mm	82.5 mm	21 mm	25