

PRODUCT NUMBER

71600-YXXXLF

- LEAD FREE, SEE NOTE 6
- COLOR OPTION, SEE NOTE 1
- TOTAL NB OF POSITION 04 TO 64 SEE SHEET 2
- OPTIONAL STRAIN RELIEF SEE SHEET 2

TRIANGLE INDICATES POSITION 1  
NOTE 5

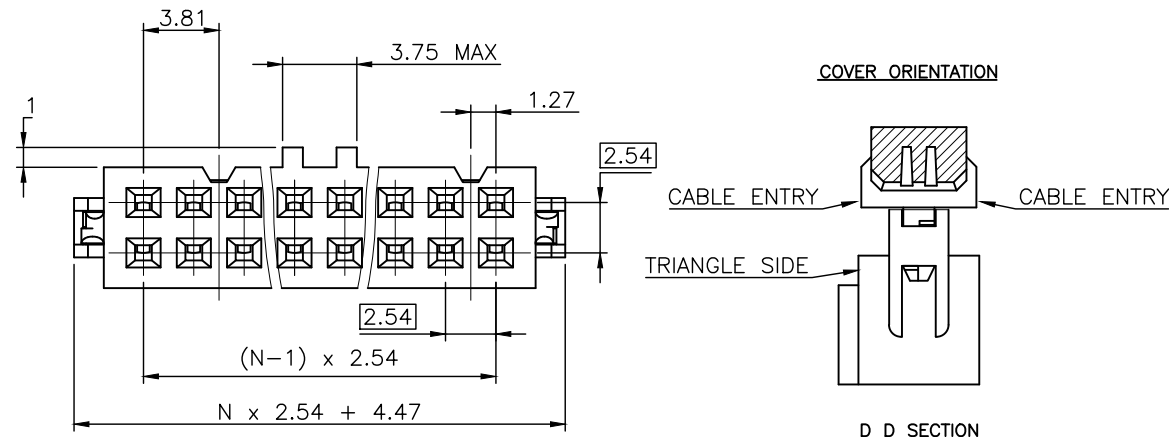
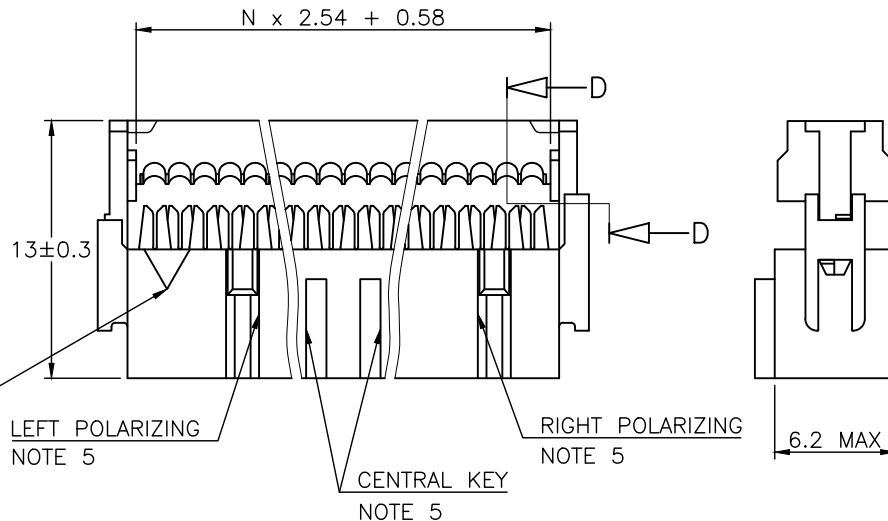

NOTES:

- 1 - HOUSING MATERIAL : GLASS FILLED THERMOPLASTIC. UL94V-0 COLOR: GREY  
 = STANDARD COLOR GREY  
 B = OPTION COLOR BLACK
- 2 - PIN MATERIAL : PHOSPHOR BRONZE
- 3 - PRODUCT PACKAGED IN TUBES.
- 4 - TO DETERMINE DIMENSIONS :  
 N = NUMBER OF POSITIONS PER ROW  
 EXAMPLE : 8 POS N x 2.54 = 20.32mm
- 5 - 2x5, 2x6, 2x7 HAVE NO LEFT POLARIZING SLOT.  
 - 2x2, 2x3 WITH CENTRAL KEY HAVE NO TRIANGLE, NO LEFT AND RIGHT POLARIZING SLOT.  
 - 2x2 WITHOUT CENTRAL KEY HAS NO LEFT AND RIGHT POLARIZING SLOT.  
 - 2x3, 2x4 WITHOUT CENTRAL KEY HAVE NO LEFT POLARIZING SLOT  
 - 2x4 WITH CENTRAL KEY HAVE NO LEFT AND RIGHT POLARIZING SLOT
- 6 - THIS PRODUCT MEETS EUROPEAN UNION DIRECTIVES AND OTHER COUNTRY REGULATIONS AS PER GS-22-008. PACKAGING SPECIFICATION AS PER GS-14-920.

|                          |  |                                       |  |                               |  |                  |  |                                       |  |
|--------------------------|--|---------------------------------------|--|-------------------------------|--|------------------|--|---------------------------------------|--|
| mat'l. code<br>SEE NOTES |  | surface<br>ISO 1302 ✓                 |  | tolerance<br>ISO 406 ISO 1101 |  | projection<br>mm |  | product family<br>2.54MM IDC          |  |
| lfr ecn no dr date       |  | tolerances unless otherwise specified |  | angles                        |  | linear           |  | title<br>QUICKIE III FEM<br>0.76µm Au |  |
| AP F12-0046 LMU 12.04.25 |  | X.X ±0.3                              |  | X.XX ±0.13                    |  | X.XXX ±0.05      |  | scale 5:1                             |  |
| AR B-17851 LMU 14.06.05  |  | D.LE 01.01.24                         |  | P.NZ 01.01.24                 |  | P.NZ 01.01.24    |  | dwg no<br>71600                       |  |
| AS F-26816 LMU 17.06.06  |  | enr 06.09.12                          |  | chr 06.09.25                  |  | appd 09.12.15    |  | sheet 1 of 2 size<br>A3               |  |
| AL F06-0270 LMU 06.09.12 |  | P.NZ 01.01.24                         |  | P.NZ 01.01.24                 |  | P.NZ 01.01.24    |  | type<br>CUSTOMER Drawing              |  |
| AM F06-0274 LMU 06.09.25 |  | P.NZ 01.01.24                         |  | P.NZ 01.01.24                 |  | P.NZ 01.01.24    |  |                                       |  |
| AN F09-0233 LMU 09.12.15 |  | P.NZ 01.01.24                         |  | P.NZ 01.01.24                 |  | P.NZ 01.01.24    |  |                                       |  |
| sheet index              |  | revision sheet                        |  | AS 1                          |  | AG 2             |  |                                       |  |

| STRAIN RELIEF OPTION AVAILABILITY | Nbr OF POSITIONS |
|-----------------------------------|------------------|
| 1/6                               | 04               |
| 0/1/2/3/6                         | 06               |
| 0/1/2/3/6                         | 08               |
| 0/1/2/3/6                         | 10               |
| 0/1/2/3/6                         | 14               |
| 0/1/2/3/6                         | 16               |
| 0/1/2/3/6                         | 18               |
| 0/1/2/3/6                         | 20               |
| 0/1/3                             | 24               |
| 0/1/2/3/6                         | 26               |
| 0/1/2/3/6                         | 30               |
| 0/1/2/3/6                         | 34               |
| 0/1/2/3/6                         | 40               |
| 0/1/2/3/6                         | 50               |
| 0/1/2/3/6                         | 60               |
| 0/1/2/3/6                         | 64               |

|           |
|-----------|
| 624       |
| 304       |
| 204 / 224 |
| 004       |

DASHES NOT AVAILABLE

**PLATING**  
 0.76µm GOLD ON CONTACT AREA  
 1.27 µm Ni REMAINDER OF PRODUCT

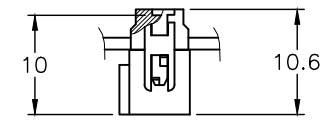

WITHOUT STRAIN RELIEF

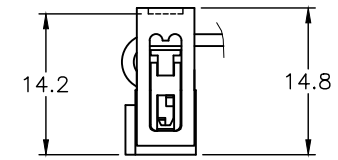

WITH LOW PROFILE STRAIN RELIEF

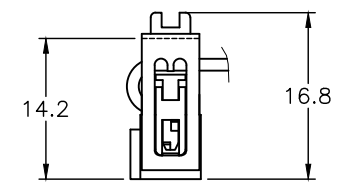

WITH STANDARD STRAIN RELIEF

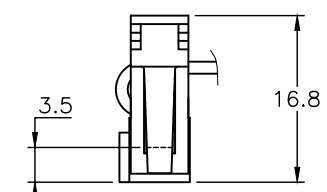

WITH LATCHING STRAIN RELIEF

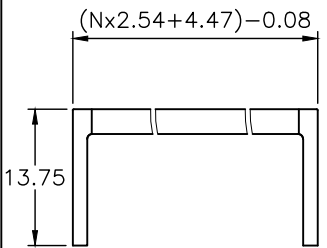

LOW PROFILE STRAIN RELIEF

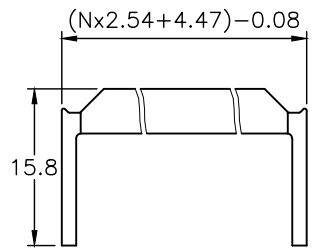

STANDARD STRAIN RELIEF

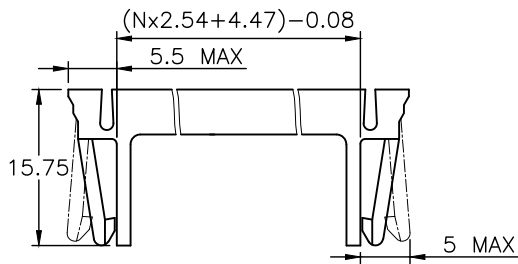

LATCHING STRAIN RELIEF FOR SLIM HEADER

| PRODUCT NUMBER | WITH CENTRAL KEY | WITHOUT CENTRAL KEY | STANDARD STRAIN RELIEF | WITHOUT STRAIN RELIEF | LOW PROFILE STRAIN RELIEF | LATCHING STRAIN RELIEF |
|----------------|------------------|---------------------|------------------------|-----------------------|---------------------------|------------------------|
| 71600-6YY(B)LF | ●                |                     |                        |                       |                           | ●                      |
| 71600-3YY(B)LF |                  | ●                   | ●                      |                       |                           |                        |
| 71600-2YY(B)LF | ●                |                     |                        | ●                     |                           |                        |
| 71600-1YY(B)LF | ●                |                     |                        | ●                     |                           |                        |
| 71600-0YY(B)LF | ●                |                     | ●                      |                       |                           |                        |

|             |                |                  |            |                   |
|-------------|----------------|------------------|------------|-------------------|
| mat'l. code | surface        | tolerance        | projection | product family    |
|             | ISO 1302       | ISO 406 ISO 1101 | mm         | QUICKIE           |
| ltr         | ecn no         | dr               | date       | title             |
| AF          | B-17851        | LMU              | 14.06.05   | IDC RECEPT DR     |
| AG          | F-26816        | LMU              | 17.06.06   |                   |
| AB          | F03019         | DLE              | 03.01.23   | scale N/A         |
| AC          | F05-0180       | LMU              | 05.04.22   | dwg no            |
| AD          | F06-0270       | LMU              | 06.09.12   | 71600             |
| AE          | F06-0274       | LMU              | 06.09.25   | sheet 2 of - size |
|             |                |                  |            | A3                |
|             |                |                  |            | type              |
|             |                |                  |            | CUSTOMER Drawing  |
| sheet index | revision sheet |                  |            |                   |



Copyright FCI