

# C-SCFI 1,5/6,3X0,8 - Connector

3240052

<https://www.phoenixcontact.com/in/products/3240052>

Please be informed that the data shown in this PDF document is generated from our Online Catalog. Please find the complete data in the user documentation. Our General Terms of Use for Downloads are valid.



Slip-on sleeve, red, 0.5 ... 1.5 mm<sup>2</sup>, 6.3 x 0.8

## Your advantages

- "Easy Entry" for easy and reliable conductor entry
- Halogen-free
- Hard-soldered crimping zone for maximum pull-out forces
- Electrogalvanized

## Commercial Data

Item number	3240052
Packing unit	100 pc
Minimum order quantity	100 pc
Sales Key	BH3
Product Key	BH3451
Catalog Page	Page 499 (C-3-2019)
GTIN	4046356452700
Weight per Piece (including packing)	1.01 g
Weight per Piece (excluding packing)	0.986 g
Customs tariff number	85366990
Country of origin	CN

# C-SCFI 1,5/6,3X0,8 - Connector

3240052

<https://www.phoenixcontact.com/in/products/3240052>

## Technical Data

### Product properties

Product type	Connector
--------------	-----------

### Electrical properties

Fuse	yes
------	-----

### Dimensions

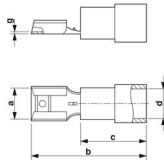
Dimensional drawing	
Width	6.3 mm
Length	21.5 mm
Length of the insulating material sleeve	10.5 mm
Maximum stripping length	7 mm
Min. material thickness	0.4 mm
Inner dimensions of the insulating collar	4.1 mm

### Material specifications

Color	red
Material	Brass
Flammability rating according to UL 94	V2
Coating	tin-plated
Insulating material	PA
Components	halogen-free

### Environmental and real-life conditions

#### Ambient conditions

Ambient temperature (operation)	-20 °C ... 105 °C
---------------------------------	-------------------

# C-SCFI 1,5/6,3X0,8 - Connector

3240052

<https://www.phoenixcontact.com/in/products/3240052>



## Drawings

Dimensional drawing

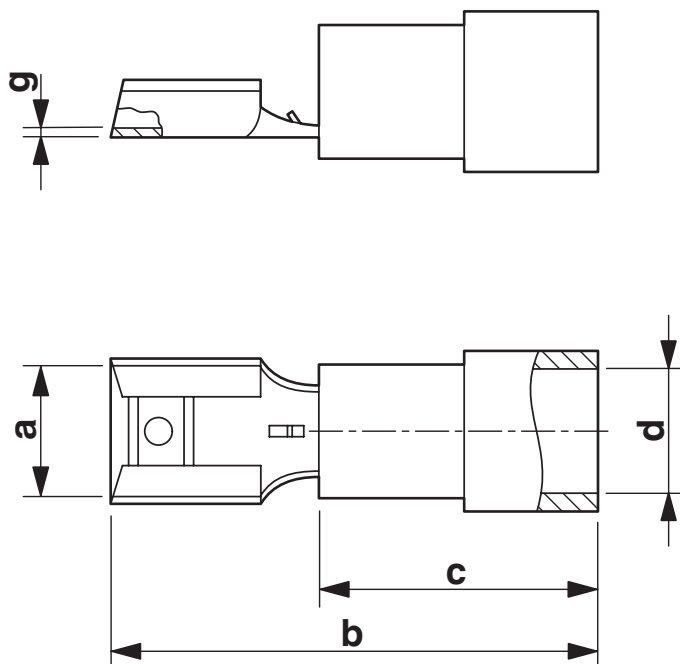

# C-SCFI 1,5/6,3X0,8 - Connector



3240052

<https://www.phoenixcontact.com/in/products/3240052>

## Classifications

### ECLASS

ECLASS-11.0	27400204
ECLASS-12.0	27400204
ECLASS-12.0	27400204
ECLASS-12.0	27400204

### ETIM

ETIM 8.0	EC001052
----------	----------

### UNSPSC

UNSPSC 21.0	27121700
-------------	----------

# C-SCFI 1,5/6,3X0,8 - Connector



3240052

<https://www.phoenixcontact.com/in/products/3240052>

## Environmental Product Compliance

China RoHS	Environmentally friendly use period: unlimited = EFUP-e
	No hazardous substances above threshold values

# C-SCFI 1,5/6,3X0,8 - Connector

3240052

<https://www.phoenixcontact.com/in/products/3240052>



## Accessories

### CRIMPFOX-RCI 2,5 - Crimping pliers

1212053

<https://www.phoenixcontact.com/in/products/1212053>



Crimping pliers, for insulated cable lugs, 0.5 mm<sup>2</sup> ... 2.5 mm<sup>2</sup> (red, blue), oval crimp

---

### CRIMPFOX-RCI 2,5-M - Crimping pliers

1212728

<https://www.phoenixcontact.com/in/products/1212728>



**Crimping pliers**, compact pliers, for insulated cable lugs (red, blue), two marked die stations, unlockable pressure lock, lateral entry

# C-SCFI 1,5/6,3X0,8 - Connector

3240052

<https://www.phoenixcontact.com/in/products/3240052>



## CRIMPFOX-RCI 6 - Crimping pliers

1212057

<https://www.phoenixcontact.com/in/products/1212057>



Crimping pliers, for insulated cable lugs, 0.5 mm<sup>2</sup> ... 6.0 mm<sup>2</sup> (red, blue, yellow), oval crimp, symmetrical

---

## CRIMPFOX-RCI 6-1 - Crimping pliers

1212059

<https://www.phoenixcontact.com/in/products/1212059>



Crimping pliers, for insulated cable lugs, 0.5 mm<sup>2</sup> ... 6.0 mm<sup>2</sup> (red, blue, yellow), oval crimp, asymmetrical

# C-SCFI 1,5/6,3X0,8 - Connector

3240052

<https://www.phoenixcontact.com/in/products/3240052>



## CRIMPFOX-RCI 6-M - Crimping pliers

1212730

<https://www.phoenixcontact.com/in/products/1212730>



Crimping pliers, compact pliers, for symmetrical insulated cable lugs, 0.5 mm<sup>2</sup> ... 6.0 mm<sup>2</sup> (red, blue, yellow), three marked die stations, unlockable pressure lock, lateral entry

---

## CF 500/DIE RCI 1,5 - Crimp insert

1212263

<https://www.phoenixcontact.com/in/products/1212263>

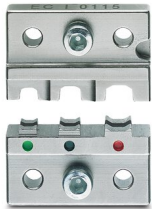

Die for crimping machine CF 500, for insulated cable lugs (C-RCI... and C-FCI...)  
0.14 ... 1.5 mm<sup>2</sup>



# C-SCFI 1,5/6,3X0,8 - Connector

3240052

<https://www.phoenixcontact.com/in/products/3240052>



## CF 500/DIE RCI 6 - Crimp insert

1212240

<https://www.phoenixcontact.com/in/products/1212240>



Die for crimping machine CF 500, for insulated cable lugs (C ... RCI... and C ... FCI...) 0.5 ... 6 mm<sup>2</sup>

---

Phoenix Contact 2023 © - all rights reserved

<https://www.phoenixcontact.com>

PHOENIX CONTACT (I) Pvt. Ltd.

A-58/2, Okhla Industrial Area, Phase - II, New Delhi-110 020

+91.1275.71420

[info@phoenixcontact.co.in](mailto:info@phoenixcontact.co.in)