

D-Sub Standard Board Mount Connectors

Amphenol's D-Subminiature connectors are part of an industry standard for applications requiring robust and reliable connectors. These proven D-Subminiature connectors are one of the most popular Input/Output interconnects, addressing a wide variety of applications in Telecommunications, Data, Consumer Industrial, Military, Instrumentation and Medical. Since many years Amphenol has been offering a wide range of D-Subminiature connectors to meet various design requirements including those in harsh environment.

The standard density D-Subminiature series are widely used for numerous applications in many market segments. Amphenol offers Delta-D (single shell design) and Frugal-D (two shell design) under this category. Standard density D-subminiature PCB mount connectors available in straight and angled version. They come with a large number of mounting options.



TARGET MARKETS



FEATURES

- A Basic I/O connector comes with five shell size and housing design
- Has a D-shaped shell design
- Meets DIN 41652 and MIL-C-24308 dimensional standards
- Available in Straight, Angle, Wire Wrap terminations
- Delta-D design (1 shell + 1 housing) with stamped & formed contacts
- Various PCB and Panel mounting accessory options available
- Lead-free and RoHS compliant

BENEFITS

- Most popular Rugged and sturdy I/O connector
- Supports the need for polarisation
- Interchangeable and intermateable with other makes
- Support different PCB mounting requirements
- Price competitive
- Wide variety of choices for secure connection
- Meets environmental, health and safety requirements

▶ D-Sub Standard Board Mount Connectors

RIGHT ANGLE SOLDER TO BOARD



UL RECOGNISED FILE E66906

- In compliance with DIN 41652

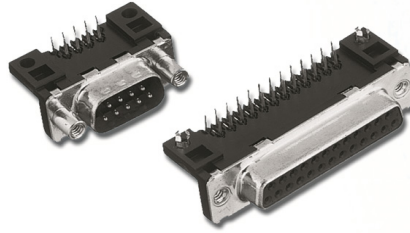

ORDERING INFORMATION

D	25	P	13A	4	GV	00LF
Series:						
Number of Contacts						
09						
15						
25						
37						
Contacts						
Pin	P					
Socket	S					
Termination					Code	
Type	Footprint/ Pitch	Length of Termination	PCB Thickness			
Right angled – Europe standard	10.4/ 2.54mm	2.90	1.6	13A	✓	
Right angled – Europe standard	10.4/ 2.54mm	3.70	2.4 and 1.6	13B		
Right angled – Europe standard	10.4/ 2.84mm	2.90	1.6	23A		
Right angled – Europe standard	10.4/ 2.84mm	3.70	2.4 and 1.6	23B		
Right angled – US standard	8.08/ 2.84mm	3.18	1.6	33E	✓	
Durability						
Standard class (≥200 mating/ unmating)					4	
High performance class (≥500 mating/unmating)					6	
RoHS Status						
Standard, RoHS compatible					00LF	
Mouting Options						
Standard hole					PA	
Threaded insert M3					PL	
Threaded insert UNC 4–40					PX	
Female screw UNC 4–40					PV	
Harpoons + insert M3 + elec. continuity					GL	
Harpoons + insert UNC 4–40 + elec. continuity					GX	✓
Harpoons + female screw UNC 4–40+ elec. continuity					GV	✓
Harpoons + female screw M3 + elec. continuity					GI	
Elec. continuity					UA	
Insert M3 + elec. continuity					UL	
Insert UNC 4–40 + elec. continuity					UX	
Female screw UNC 4–40 + elec. continuity					UV	

► D-Sub Standard Board Mount Connectors

SPECIFIC DIMENSIONS

EUROPE STANDARD

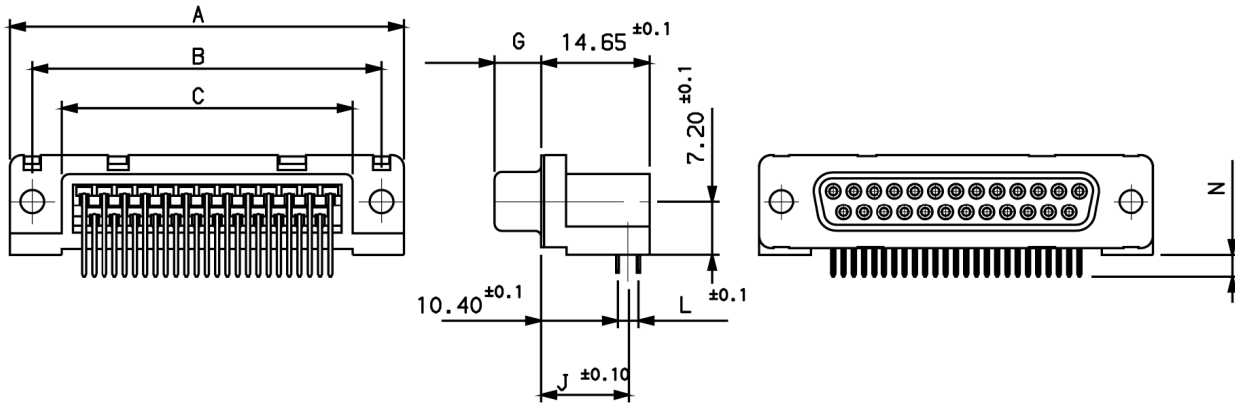

US STANDARD

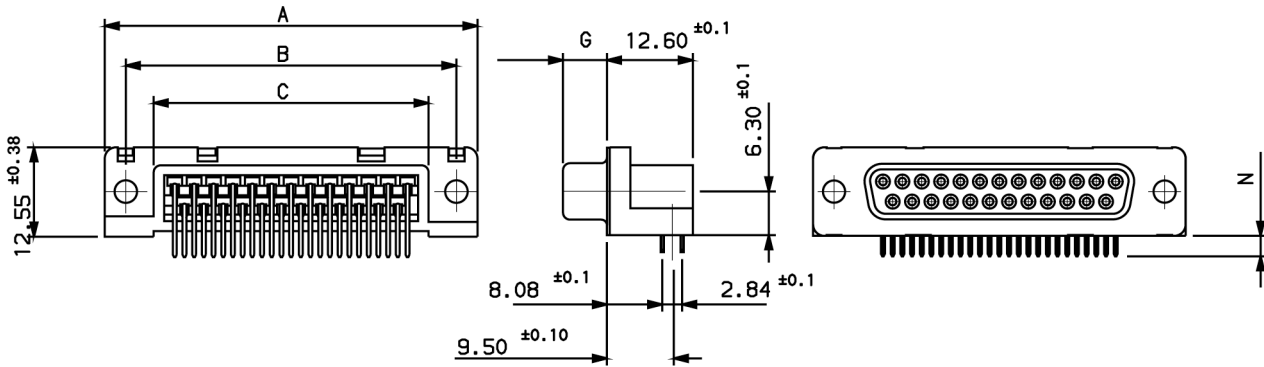

		A ^{±0,38}	B ^{±0,12}	C ^{±0,10}	G ^{-0/+0,25}	J ^{±0,10}		L ^{±0,10}		N ^{±0,30}		
						Termination		Termination		Termination Length		
						13	23	13	23	13A 23A	13B 23B	33E
09	P	30.81	24.99	16.96	5.90 ^{-0/+0,15}	11.67	11.82	2.54	2.84	2.90	3.70	3.18
	S	30.81	24.99	16.96	6.05	11.67	11.82	2.54	2.84	2.90	3.70	3.18
15	P	39.14	33.32	25.18	5.90 ^{-0/+0,15}	11.67	11.82	2.54	2.84	2.90	3.70	3.18
	S	39.14	33.32	25.18	6.05	11.67	11.82	2.54	2.84	2.90	3.70	3.18
25	P	53.03	47.04	39.12	5.70	11.67	11.82	2.54	2.84	2.90	3.70	3.18
	S	53.03	47.04	39.12	6.05	11.67	11.82	2.54	2.84	2.90	3.70	3.18
37	P	69.32	63.50	55.68	5.70	11.67	11.82	2.54	2.84	2.90	3.70	3.18
	S	69.32	63.50	55.68	6.05	11.67	11.82	2.54	2.84	2.90	3.70	3.18

Dimensions in mm

► D-Sub Standard Board Mount Connectors

STRAIGHT SOLDER TO BOARD

UL® **UL RECOGNISED FILE E66906**



ORDERING INFORMATION

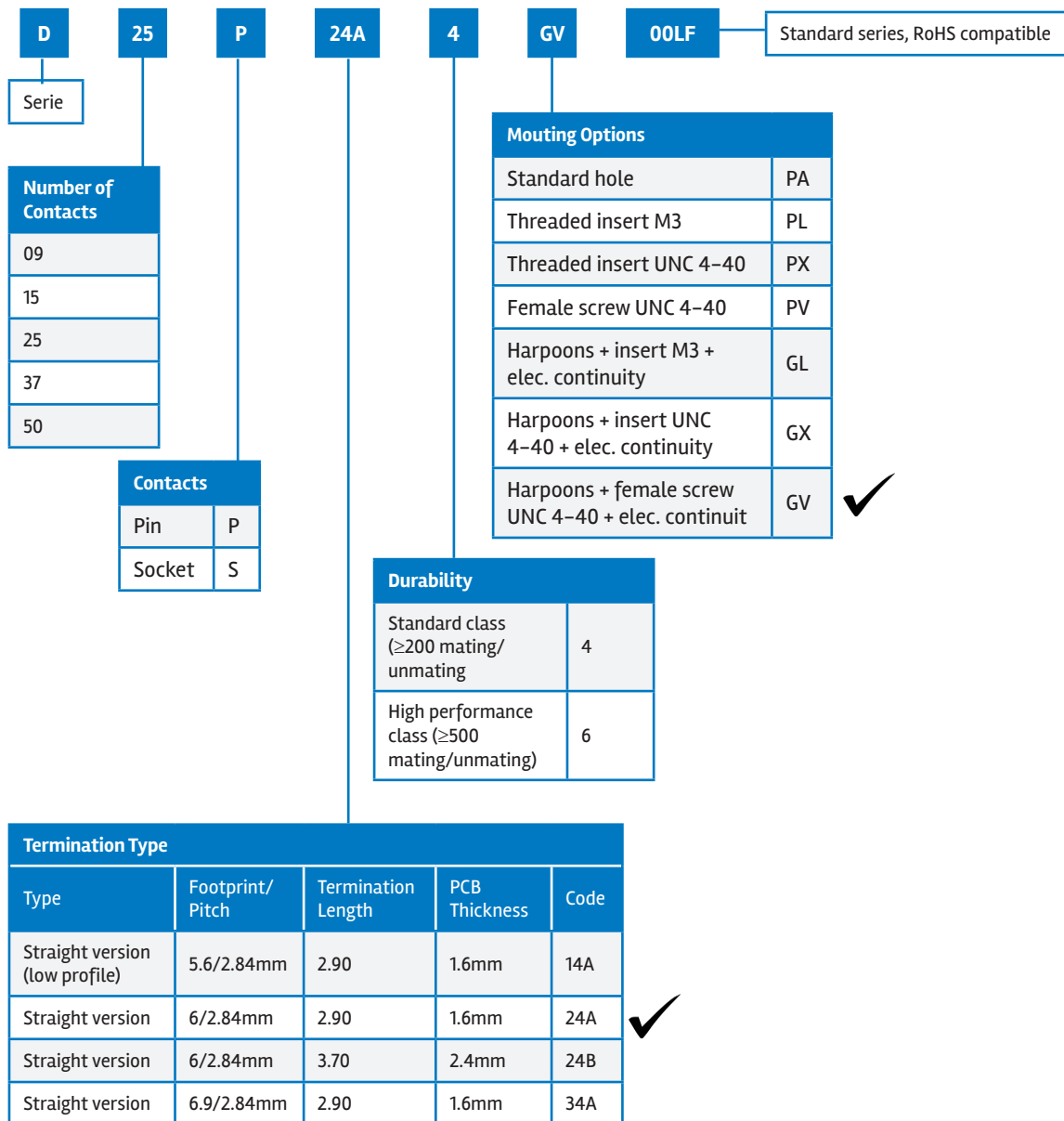

Preferred Option ✓

► D-Sub Standard Board Mount Connectors

SPECIFIC DIMENSIONS

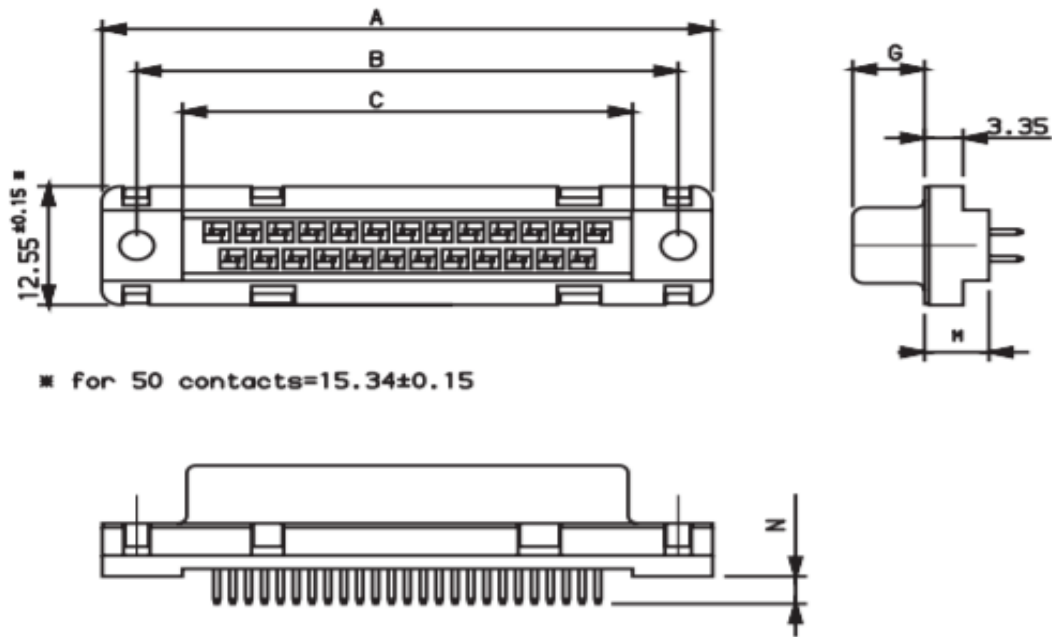

Dimensions										
		A ± 0.38	B ± 0.12	C ± 0.10	G $-0/+0.25$	M ± 0.10			N ± 0.30	
						Terminal			Terminal Length	
						14	24	34	14A 24A 34A	24B
09	P	30.81	24.99	16.96	5.90 $-0/+0.15$	5.60	6.00	6.90	2.90	3.70
	S	30.81	24.99	16.96	6.05	5.60	6.00	6.90	2.90	3.70
15	P	39.14	33.32	25.18	5.90 $-0/+0.15$	5.60	6.00	6.90	2.90	3.70
	S	39.14	33.32	25.18	6.05	5.60	6.00	6.90	2.90	3.70
25	P	53.03	47.04	39.12	5.70	5.60	6.00	6.90	2.90	3.70
	S	53.03	47.04	39.12	6.05	5.60	6.00	6.90	2.90	3.70
37	P	69.32	63.50	55.68	5.70	5.60	6.00	6.90	2.90	3.70
	S	69.32	63.50	55.68	6.05	5.60	6.00	6.90	2.90	3.70
50	P	67.10	61.11	54.11	5.70	5.60	6.00	6.90	2.90	3.70
	S	67.10	61.11	54.11	6.05	5.60	6.00	6.90	2.90	3.70

Dimensions in mm

▶ D-Sub Standard Board Mount Connectors

STAMPED AND ROLLED CONTACTS



UL RECOGNISED FILE E 66906

D series is the standard D-Sub full metal shell version with stamped contacts. This design is basically proposed in straight and angled version without accessories



PART NUMBER SELECTOR

D	E	09	P	5	64	C	T	X	LF	
SERIES	SHELL SIZE	LOCKING ACCESSORIES	TOTAL CONTACTS	CONTACTS TYPE	TERMINATION TYPE	MATING CYCLES	TERMINATION TYPE	SHELL PLATING	DIMPLES	LEAD-FREE
D			09 15 25 37 50	Pin P Socket S		≥200 64 ≥500 65		Standard tin plating T		LF
E A B C D										
				Straight 3 Right Angle (Foot Print/Pitch: 10.40/2.54mm) 5	Stamped contacts				Standard on male connector only X	
Blank	Standard									
L	Threaded Insert M3									
O	Threaded Insert UNC 4-40									
V	Female screw (Hexagonal) UNC 4-40									

Straight Spills	Angled Spills	Index
Without accessory	Two plastic brackets*	-
-	Without bracket	C
-	Two metal brackets	M
Harpoons (Compulsory with option L or V)	Harpoons	G

*Except 50 pos with monobloc plastic brackets

SPECIFIC DIMENSIONS

Straight Spills

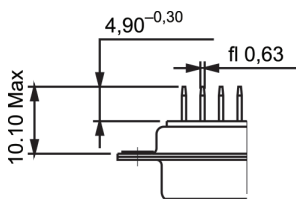

Right Angle Spills

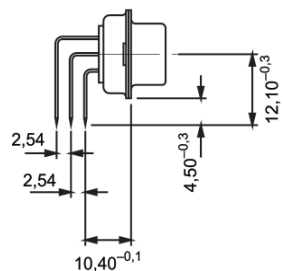
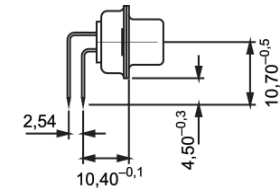

▶ D-Sub Standard Board Mount Connectors

MACHINED CONTACTS



UL RECOGNISED FILE E 66906

- DP series is designed for high performance applications, particularly in the field of telecommunications: data transmission, private automatic branch switching, telecom (LNZ listed)

- It features machined contacts and is available with straight spills, angled spills, and wire wrap terminations

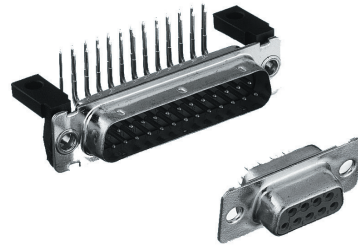

PART NUMBER SELECTOR

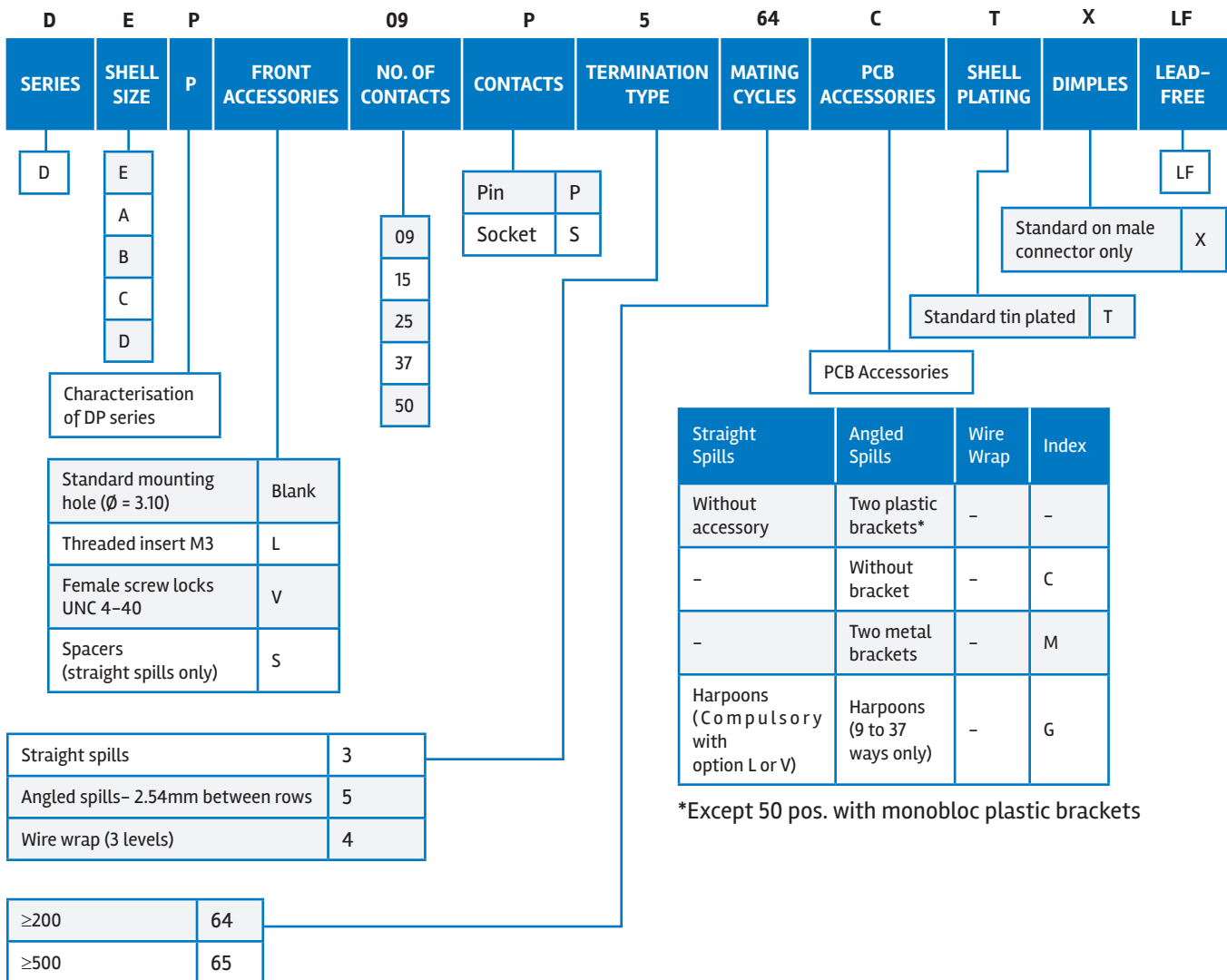

► D-Sub Standard Board Mount Connectors

SPECIFIC DIMENSIONS

Wire Wrap

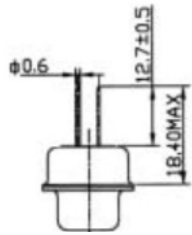

Right Angle Spills

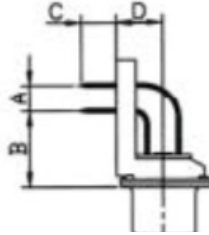

Straight Spills

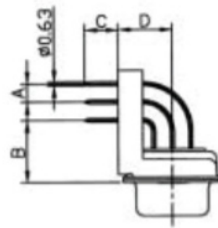
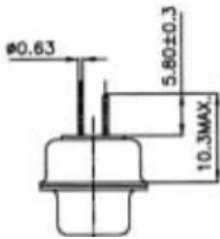

Dimension		Termination Code
		5
A		2.54
$B^{\pm 0.1}$		10.30
$C^{\pm 0.5}$		4.00
$D^{\pm 0.19}$	9 to 37 contacts	7.20
	50 contacts	8.60

▶ D-Sub Standard Board Mount Connectors

TARGET MARKETS/APPLICATIONS



Asymmetric Digital Subscriber Line
(ADSL)
Base Station
Switching
Transmission



Set-top Box



Desktop and Laptop
Storage System
Router and Server



Automotive Diagnostics
Control Drives
Energy Meter
Gaming Machine
Test Equipment
Office Automation
POS & Handheld terminal
Power Supplies
Parking Meter
Printer and Copier
Renewable Energy
Robotics
Surveillance Camera
Avionics



Medical Instrument



Military Equipment

IN0DSUBSTDBMT082IEA4