

# EV-GBDC-PARK-SW - Charging connector holder



1623497

<https://www.phoenixcontact.com/in/products/1623497>

Please be informed that the data shown in this PDF document is generated from our Online Catalog. Please find the complete data in the user documentation. Our General Terms of Use for Downloads are valid.



CHARX connect, Charging connector holder, Accessories, for vehicle charging connectors on charging stations (EVSE), GB/T, GB/T 20234.3, Front mounting, Park position with pushbutton (N/C contact) to detect the plug state., housing: black

## Product Description

Retainer for Vehicle Connector as parking position at charging stations for E-Mobility (EVSE)

## Your advantages

- Developed and produced in accordance with the IATF 16949 automotive standard and ISO 9001
- Individual branding, thanks to the use your own logo

## Commercial Data

Item number	1623497
Packing unit	1 pc
Minimum order quantity	1 pc
Sales Key	XWB
Product Key	XWBAJG
Catalog Page	Page 43 (C-7-2019)
GTIN	4055626193878
Weight per Piece (including packing)	131.6 g
Weight per Piece (excluding packing)	131 g
Customs tariff number	39269097
Country of origin	CN

1623497

<https://www.phoenixcontact.com/in/products/1623497>

## Technical Data

### Product properties

Product type	Charging connector holder
Product family	CHARX connect
Application	for vehicle charging connectors on charging stations (EVSE)
Type	Accessories
Charging standard	GB/T
Charging mode	Mode 4

### Dimensions

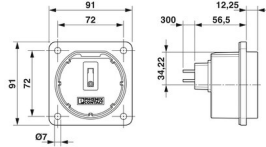
Dimensional drawing	
Bore dimensions	72 mm x 72 mm
Width	91 mm
Height	91 mm
Depth	68.75 mm

### Material specifications

Color (Housing)	black (9005)
Material (Housing)	Plastic
Flammability rating according to UL 94	V0 ( )

### Mechanical properties

Securing	With actuation lever
Detection	Park position with pushbutton (N/C contact) to detect the plug state.
Removal	Lever actuation and removal

### Environmental and real-life conditions

#### Ambient conditions

Degree of protection	IP54 (plugged in)
Ambient temperature (operation)	-30 °C ... 50 °C
Ambient temperature (storage/transport)	-40 °C ... 80 °C

### Standards and regulations

#### Standards

Standards/regulations	GB/T 20234.3
-----------------------	--------------

### Mounting

# EV-GBDC-PARK-SW - Charging connector holder



1623497

<https://www.phoenixcontact.com/in/products/1623497>

Mounting type Charging connector holder	Front mounting (0° ... 45° frontal inclination possible)
Mounting hole diameter	7.00 mm

1623497

<https://www.phoenixcontact.com/in/products/1623497>

## Drawings

Dimensional drawing

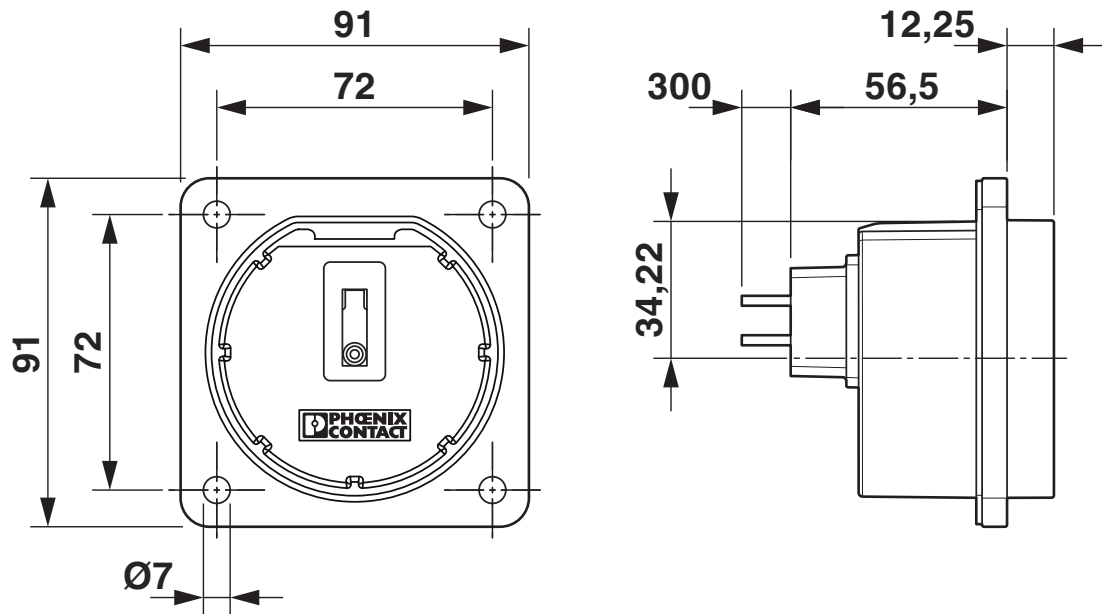

Dimensional drawing

1623497

<https://www.phoenixcontact.com/in/products/1623497>

Drilling plan/solder pad geometry

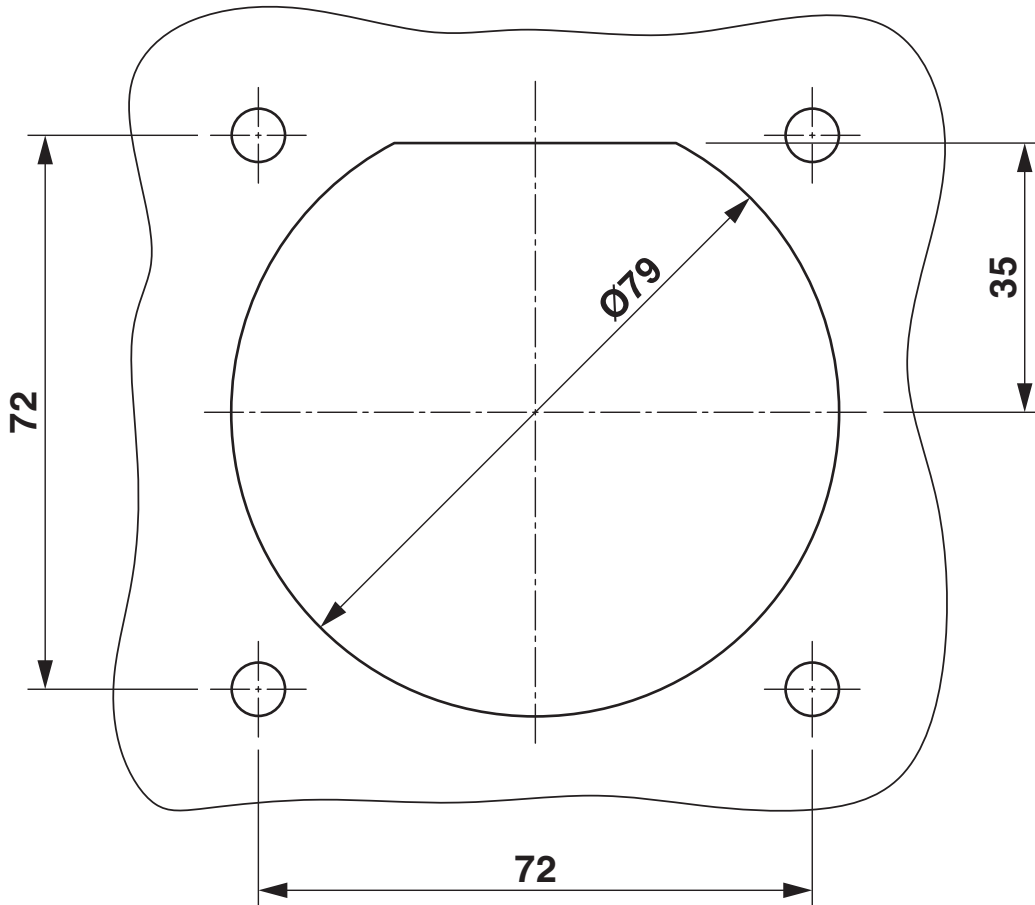

Hole image

1623497

<https://www.phoenixcontact.com/in/products/1623497>

## Classifications

### ECLASS

ECLASS-11.0	27144792
ECLASS-13.0	27144792

### ETIM

ETIM 8.0	EC002884
----------	----------

### UNSPSC

UNSPSC 21.0	39121500
-------------	----------

# EV-GBDC-PARK-SW - Charging connector holder



1623497

<https://www.phoenixcontact.com/in/products/1623497>

## Environmental Product Compliance

China RoHS	Environmentally friendly use period: unlimited = EFUP-e
	No hazardous substances above threshold values

Phoenix Contact 2023 © - all rights reserved  
<https://www.phoenixcontact.com>

PHOENIX CONTACT (I) Pvt. Ltd.  
A-58/2, Okhla Industrial Area, Phase - II, New Delhi-110 020

+91.1275.71420  
[info@phoenixcontact.co.in](mailto:info@phoenixcontact.co.in)