

STRAIGHT PLUGS, FULL CRIMP TYPE, FOR FLEXIBLE CABLES

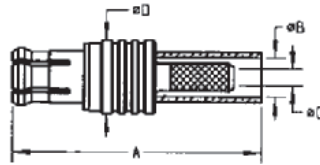

Cable group	Cable group dia.	Part number	Imp. (Ω)	Dimensions (mm)				Captive center contact	Finish
				A	B	C	D		
RG178/RG196	2/50/S	R113 081 000	50	16.1	2.55	1.1	5	no	Gold
RG174/RG316	2.6/50/S	R113 082 000		16.1	2.95	1.65			Gold
		R113A 082 000		18.7	-	1.55		Gold ECO version	
RD316	2.6/50/D	R113 083 000		16.2	3.25	1.65		Gold	
		R113A 083 000		18.7	-	1.55		Gold ECO version	
RG179	2.6/75/S	R213 082 007	75	18.2	2.95	1.7	5.8	yes	BBR
RD179	2.6/75/D	R213 083 007		18.3	3.25				

STRAIGHT PLUGS, SOLDER TYPE, FOR SEMI-RIGID CABLES

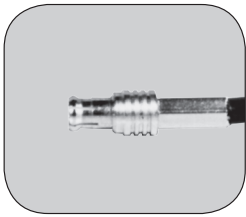
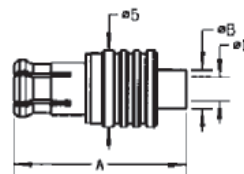
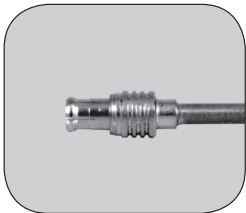

Cable group	Cable group dia.	Part number	Imp. (Ω)	Dimensions (mm)			Captive center contact	Finish
				A	B	C		
.047" semi-rigid	.047"	R113 051 000	50	11.3	2	1.3	no	Gold
RG405	.085"	R113 053 000			3	2.25		

RIGHT ANGLE PLUGS, CRIMP TYPE, FOR FLEXIBLE CABLES

(captive center contact)

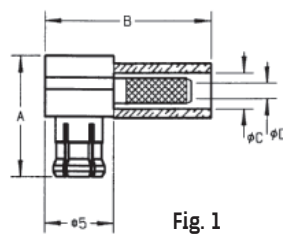
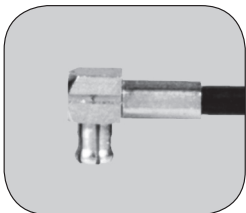

Fig. 1

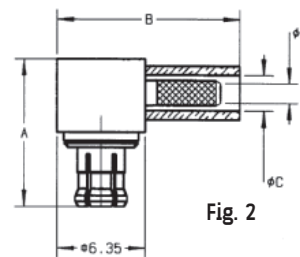

Fig. 2

Cable group	Cable group dia.	Part number	Fig.	Imp. (Ω)	Dimensions (mm)				Finish
					A	B	C	D	
RG178/RG196	2/50/S	R113 181 000	1	50	8.6	11.9	2.55	1.1	Gold
RG174/RG316	2.6/50/S	R113 182 000				11.9	2.95	1.65	Gold
		R113A 182 000			8.9	14.1	1.55	Gold ECO version	
RD316	2.6/50/D	R113 183 000			8.6	11.9	3.25	1.65	Gold
		R113A 183 000			8.9	14.1		1.55	Gold ECO version
RG179	2.6/75/S	R213 182 007	2	75	10.6	13.3	2.95	1.7	BBR
RD179	2.6/75/D	R213 183 007					3.25		

To download data sheets and assembly instructions, visit www.radiall.com & enter the part number in the Search box. **Bold** part numbers represent products typically in stock & available for immediate shipment. See page 8 and 9 for packaging information.