

**STRAIGHT DIPOLE SMA 2.4GHZ  
OMNIDIRECTIONAL ANTENNA**

**R380.500.127**

Series : ANTENNA

Scale 2:1

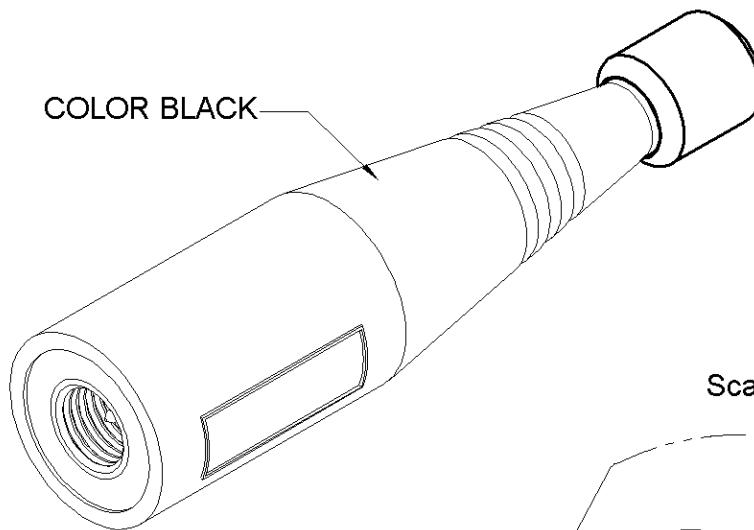
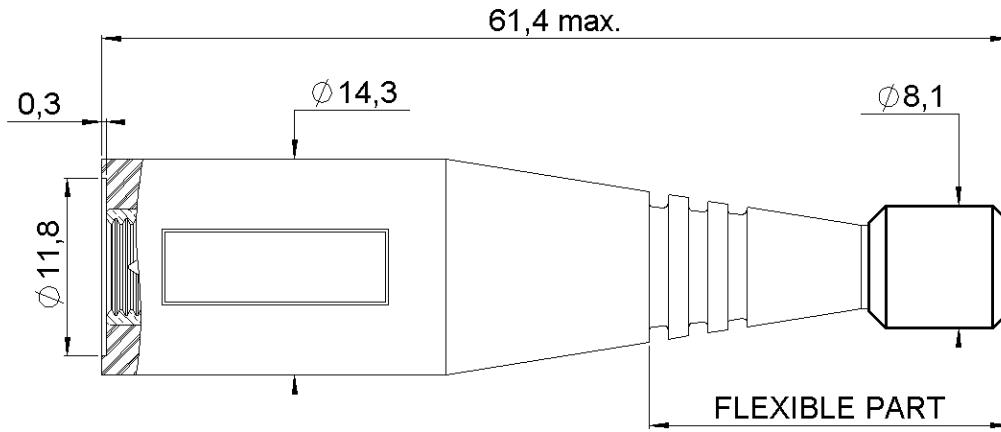

Scale 4:1

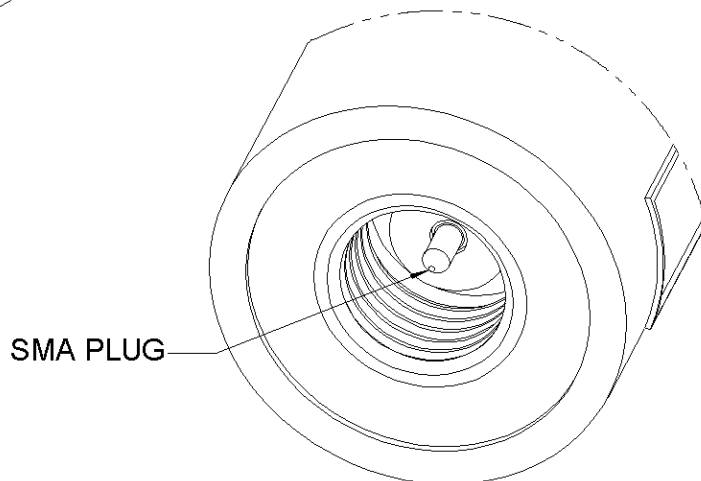

All dimensions are in mm

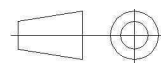

Issue : 0826 A

In the effort to improve our products, we reserve the right to make changes judged to be necessary.

**RADIAL** 

**STRAIGHT DIPOLE SMA 2.4GHZ  
OMNIDIRECTIONAL ANTENNA****R380.500.127**

Series : ANTENNA

**ELECTRICAL CHARACTERISTICS**

Frequency :	<b>2.4-2.5 GHz</b>
Nominal Impedance :	<b>50 Ω</b>
VSWR :	<b>1.5:1 Max</b>
Gain (Overall gain) :	<b>2 dBi</b>
Radiation Pattern :	<b>Omni-directional in the horizontal plane</b>
Polarization :	<b>VERTICAL</b>
Power withstanding :	<b>1 W Max</b>
Connector type :	<b>SMA Plug (gold plated)</b>

**MECHANICAL CHARACTERISTICS**

Plastic radome :	<b>HYTREL G 3548 L</b>
Color :	<b>BLACK</b>
Ingress Protection :	<b>IP 68</b>
Weight :	<b>10.1 g</b>
Overall length :	<b>61.4 mm</b>
Flexibility :	<b>100 Cycles ± 180°</b>
Pull Force :	<b>15 lb.</b>
Torque Resistance :	<b>1.6 in-lb.</b>
Flammability :	<b>UL94-HB</b>
Drop test resistance :	<b>5 ft drop to concrete (x30) mounted of a 800 g handheld terminal</b>

**Issue : 0826 A**

In the effort to improve our products, we reserve the right to make changes judged to be necessary.

**RADIAL** 

**STRAIGHT DIPOLE SMA 2.4GHZ  
OMNIDIRECTIONAL ANTENNA**

**R380.500.127**

Series : ANTENNA

**TESTS MECHANICAL**

Test report n° 2003-13-9245

**ENVIRONMENTAL CHARACTERISTICS**

Operating temperature : **-30/+55 ° C**

Storage temperature : **-40/+70 ° C**

**TESTS ENVIRONMENTAL**

Test report n° 2003-19-8353

In accordance with the DEF STAN 00-35

**PACKAGING**

Standard	Unit	Other
<b>20</b>	<b>'W' option</b>	<b>Contact us</b>

**Issue : 0826 A**

In the effort to improve our products, we reserve the right to make changes judged to be necessary.

**RADIAL** 