

EM-MP 45N - Mounting plate

2943712

<https://www.phoenixcontact.com/in/products/2943712>

Please be informed that the data shown in this PDF document is generated from our Online Catalog. Please find the complete data in the user documentation. Our General Terms of Use for Downloads are valid.

Mounting plate, for screwing on siz 0 switchgear



Commercial Data

Item number	2943712
Packing unit	10 pc
Minimum order quantity	10 pc
Sales Key	ACG
Product Key	ACGEAA
Catalog Page	Page 765 (C-1-2013)
GTIN	4017918081263
Weight per Piece (including packing)	15.77 g
Weight per Piece (excluding packing)	15.77 g
Customs tariff number	39269097
Country of origin	DE

EM-MP 45N - Mounting plate

2943712

<https://www.phoenixcontact.com/in/products/2943712>



Technical Data

Product properties

Type	Flat version, 45 mm wide
Product type	Mounting material
Housing type	DIN rail adapter

Dimensions

Dimensional drawing	
Width	45 mm
Length	68 mm

Material specifications

Color	green
Flammability rating according to UL 94	V2
Surface characteristics	untreated
Housing material	Polyamide fiber reinforced

Environmental and real-life conditions

Ambient conditions

Ambient temperature (operation)	-40 °C ... 105 °C
---------------------------------	-------------------

EM-MP 45N - Mounting plate

2943712

<https://www.phoenixcontact.com/in/products/2943712>

Drawings

Dimensional drawing

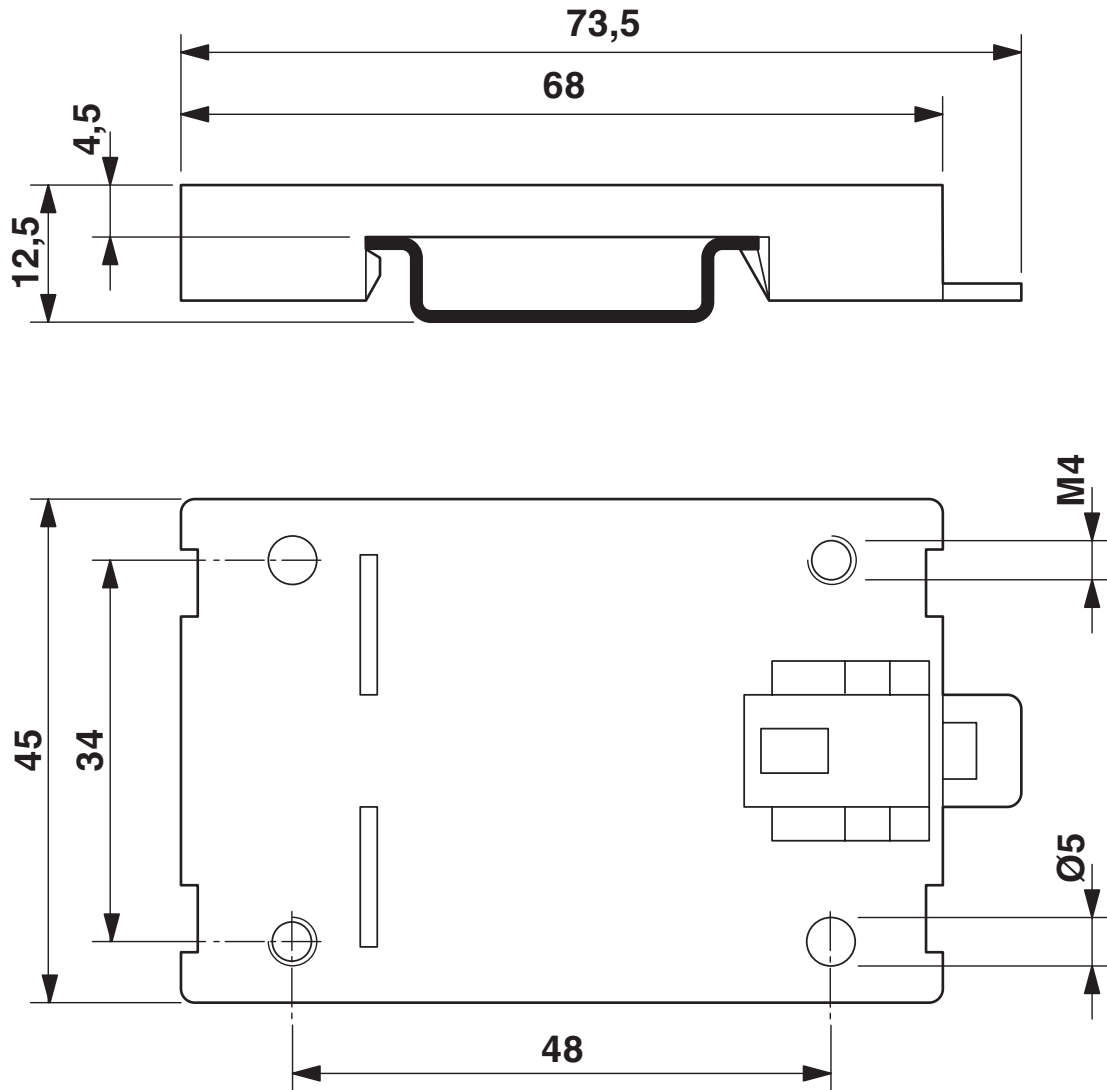

EM-MP 45N - Mounting plate

2943712

<https://www.phoenixcontact.com/in/products/2943712>



Approvals



EAC

Approval ID: B.01687

EM-MP 45N - Mounting plate



2943712

<https://www.phoenixcontact.com/in/products/2943712>

Classifications

ECLASS

ECLASS-11.0

27182702

ETIM

ETIM 8.0

EC001031

UNSPSC

UNSPSC 21.0

31261500

EM-MP 45N - Mounting plate



2943712

<https://www.phoenixcontact.com/in/products/2943712>

Environmental Product Compliance

China RoHS	Environmentally friendly use period: unlimited = EFUP-e
	No hazardous substances above threshold values

Phoenix Contact 2023 © - all rights reserved
<https://www.phoenixcontact.com>

PHOENIX CONTACT (I) Pvt. Ltd.
A-58/2, Okhla Industrial Area, Phase - II, New Delhi-110 020

+91.1275.71420
info@phoenixcontact.co.in