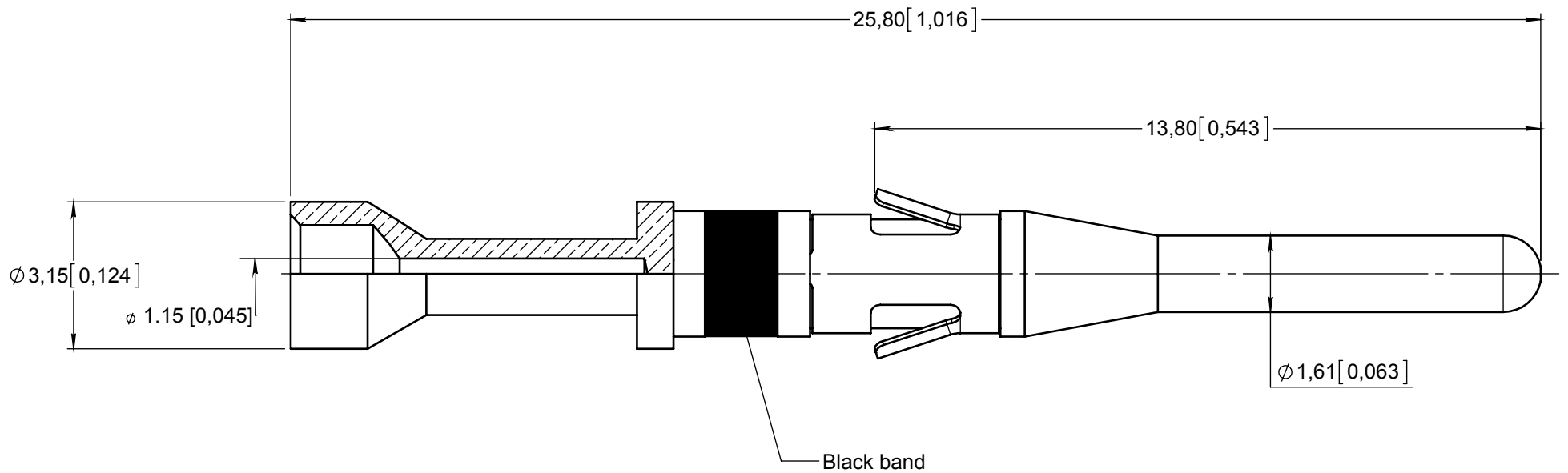

**Series  
MMC**
**CRIMP REMOVABLE PIN CONTACT  
FOR AWG 20-22-24**
**Issue:  
Mar. 30, 2015**
**Page  
1/1**

**MATERIAL AND PLATING :**

Contact body : Copper alloy gold over nickel underplate  
Retention clip : Beryllium copper - nickel

**CABLING :**

Wires accomodated : AWG 20-22-24  
Insulation diameter : 2.2 max  
Strip length : 5

**TOOLING :**

Crimping tool : M22520/1-01 RADIALL 282 291  
Selector position : 4 for AWG 20 - 3 for AWG 22 - 2 for AWG 24  
Positioner : RADIALL 282 976  
Extraction tool : RADIALL 282 920

ESTIMATED WEIGHT : 0.68 Gr.[0.0239 ounces]

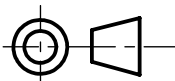
**DIMENSIONS : mm (inch are given for information only)**

**CREATION**
**PEN:**
**NOM: FALETTI**
**DATE: Feb. 08, 1988**
**APPR.:**

Mar 30, 15	Black band added - Document reviewed	YON P.	PERRIN H.	
Issue	Revisions	Name	Approved	