

PCB DRILLING DETAILS

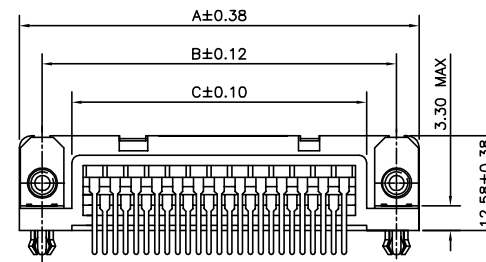

SERIES ID 25 P 33 E 4 G X 00 L F

LEAD FREE

SPECIAL CODE

00-&gt;STANDARD

## MOUNTING OPTIONS

GX-&gt;HARPOON+INSERT UNC 4 40+METAL BRACKET

GL->HARPOON+INSERTM3+METAL BRACKET

GV-&gt;HARPOON+FEMALE SCREW LOCK UNC 4 40+METAL BRACKET

## PLATING

4-&gt;FLASH Au+Sn/SnPb

 $6 \rightarrow 0.76 \mu \text{Au} + \text{Sn}/\text{SnPb}$ 

HEIGHT OF TERMINATION

E-3.18 US STANDARD

## CLINCH NUT

MATING/UNMATING CYCLES (MIN)	: 200 (FLASH Au);
	: 500 (0.76μ Au)
INSERTION/EXTRACTION FORCE PER CONTACT	: 5 N Max./ 0.3 N Min.

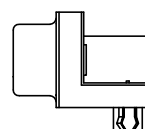
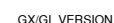

The housing will withstand exposure to 260°C peak temperature for 3.5 seconds in a wave solder application with a 1.6mm minimum thick circuit board.  
Packaging as per GS-14-920

form: A3